

NARAYANGONJ PALLI BIDYUT SAMITY-01

COST ESTIMATES FOR CONSTRUCTION OF XEN TOILET AT NARAYANGONJ PALLI BIDYUT SAMITY-01, HEAD QUARTER,
NARAYANGONJ PBS-1.

JULY - 2023

Consultant:



HPD

HOME PLANNING DEVELOPMENT LTD.

65-Link Road (Bipanon plot # 22) 2nd floor

Rasul view, Bangla-motor, Dhaka-1000

E-mail : hplanningltd@yahoo.com

ABSTRACT OF COST

COST ESTIMATES FOR CONSTRUCTION OF XEN TOILET AT NARAYANGONJ PALLI BIDYUT SAMITY-01, HEAD QUARTER, NARAYANGONJ PBS-1.

It needs mention here that the cost estimate calculations have been done following the Schedule of Rates – 2022 (Revised), of Public Works Department (PWD), Government of the People's Republic of Bangladesh effective from 23 February 2023. Details break up on the following pages:

01. Part – A : Civil Works -----	Tk.
02. Part – B : Sanitary & Water Supply Works -----	Tk.
03. Part – C : Electrical Works -----	Tk.

Grand Total Tk. 0.00

In word: Taka One lakh fifty six thousand two hundred fifty eight and paisa fifty only.

মোহাম্মদ আবদুল হান্নান
প্রকৌশল (কম্পানি/এইচআর)
নারায়গঞ্জ পবিস-১

COST ESTIMATES FOR CONSTRUCTION OF XEN TOILET AT NARAYANGONJ PALLI BIDYUT SAMITY-01, HEAD QUARTER, NARAYANGONJ PBS-1.

01. Part – A : Civil Works.

Item No.	Group	Item Code SoR-2022 of PWD	Description of Item	Measurement Unit	Total Qty.	Unit Rate (Barisal) Taka	Amount (Taka)
1	Civil	4.16 4.21	125 mm brick works with first class bricks with cement sand (F.M. 1.2) mortar (1:4) and making bond with connected walls including necessary scaffolding, raking out joints, cleaning and soaking the bricks for at least 24 hours before use and washing of sand, curing at least for 7 days in all floors including cost of water, electricity and other charges etc. all complete and accepted by the Engineer-in-charge. (Cement: CEM-II/B-M)	sqm	8		
2	Civil	6.1 6.1.1 6.27	2nd floor Supplying, fitting and fixing country made GP (Gross Porcellanto) - glazed or unglazed homogeneous floor tiles complying BDS ISO 13006: 2015, water absorption $\leq 0.5\%$, modulus of rupture (MOR) ≥ 27 N/mm ² , irrespective of color &/or design, with 20 mm thick cement sand (F.M. 1.2) mortar (1:4) base and raking out the joints with white cement including cutting and laying the tiles in proper way and finishing with care etc. all complete and accepted by the Engineer-in-charge. (Cement: CEM-II/B-M).	sqm	2		
3	Civil	6.6 6.6.2 6.27	2nd floor Supplying, fitting and fixing country made glazed wall tiles complying BDS ISO 13006: 2015, irrespective of color &/or design, with 20 mm thick cement sand (F.M. 1.2) mortar (1:3) base and raking out the joints with white cement including cutting, laying and hire charge of machine and finishing with care etc. including cost of water, electricity and other charges complete in all respect and accepted by the Engineer-in-charge. (Cement: CEM-II/B-M). Wall tiles more than 250 mm x 330 mm & less than or equal to 250 mm x 400 mm in sizes	sqm	12		

মোহাম্মদ আব্দুল আলম
 প্রকৌশল (প্রশাসন/এইচআর)
 সারায়গঞ্জ পবিস-১

SHEET NO.	01
DRAWING TITLE:	PROPOSED PLAN OF TOILET
PROJECT:	CONSTRUCTION OF TOILET IN FACILITY FOR SECURITY COMPLEX AT NARAYANCONJURU BODHIT SAMITY 01- HEADQUARTER, NARAYANCONJURU PPS-1
CLIENT:	BANGLADESH RURAL ELECTRIFICATION BOARD (BREEB)
CONSULTANT:	HOME PLANNING DEVELOPMENT LTD. Address: Gopabandhu Road, Dhaka 65 - Link Road, Bapaton Pali No. 22 Rasul View, Flat No. - 3D (2nd Floor) Bangla Motor, Dhaka - 1000. Phone: 02-55166046, 01717-25031 Email: hplanning@gmail.com
DRAWN BY:	MD. MAYEEN UDDIN
DATE:	JULY, 2023
SCALE:	AS SHOWN
REVISION:	

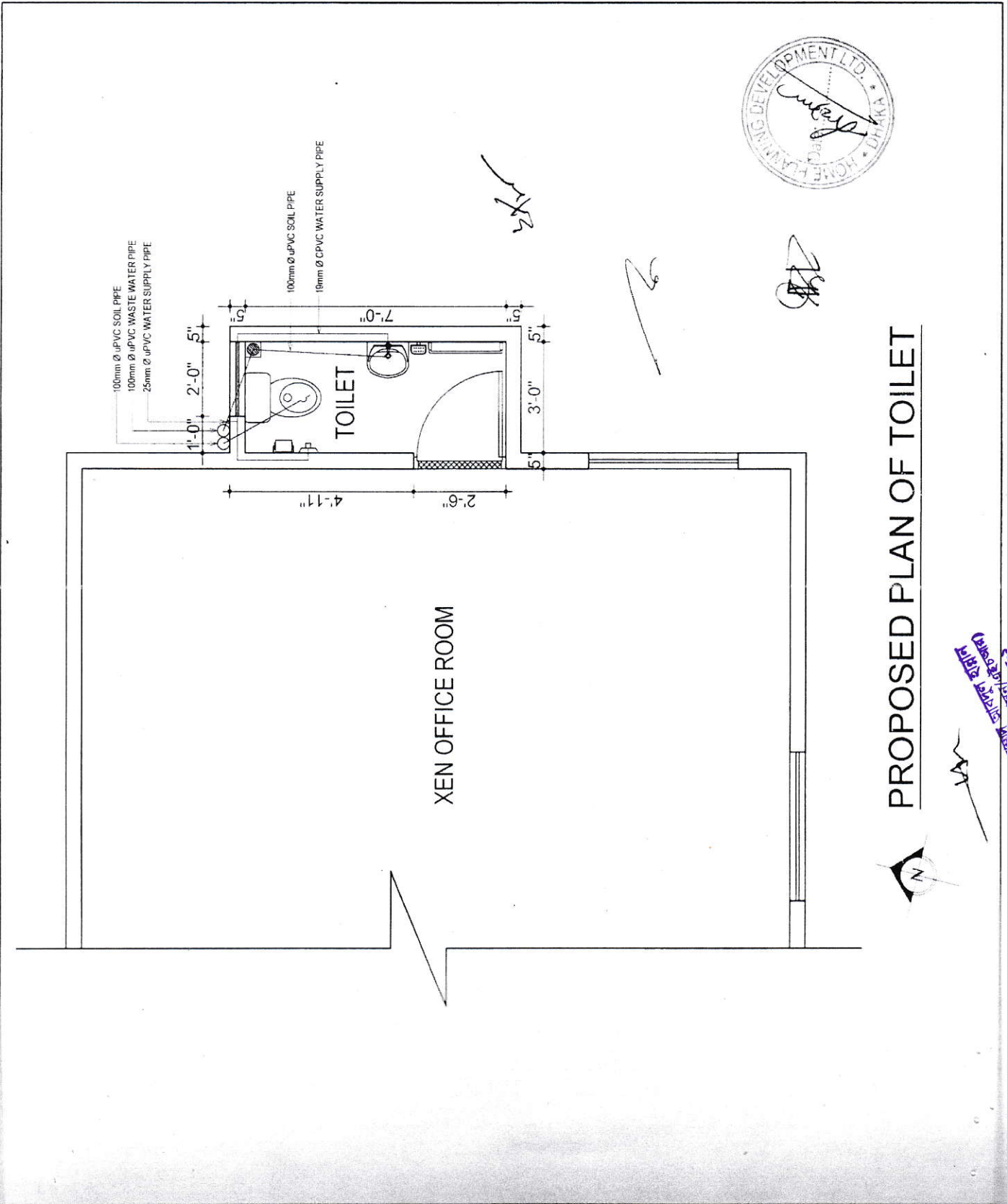

PROPOSED PLAN OF TOILET

সংস্করণ: ১০/০৭/২০২৩
 ড্রয়িং নং: ১০/০৭/২০২৩
 প্রকল্প: নারায়নকোন্জুরু পিপিএস-১



Item No.	Group	Item Code SoR-2022 of PWD	Description of Item	Measurement Unit	Total Qty.	Unit Rate (Barisal) Taka	Amount (Taka)
4	Civil	13.5.1	Supplying, fitting and fixing window grill made of 10 mm x 10 mm M.S. solid bar @ 100mm c/c with outer frame of 38 mm x 6mm F.I. bar and 25 mm x 6 mm F.I. bar for clamp as per design including fabrication, welding, cost of electricity workshop charges, carriage, cutting grooves, mending good the damages, tools and plants, finished with anti-corrosive painting (Red-Oxide) etc. complete for all floors approved and accepted by the Engineer-in-charge. (Total weight per sqm should be approx. 17 kg and add or deduct @ 100.00 for each kg/sqm excess or less respectively)	sqm	0.5		
5	Civil	14.7 14.7.2.1	Supplying, fitting and fixing of aluminium sliding window as per the U.S. Architectural Aluminium Manufacturer's Association (AAMA) standard specification and BDS 1879:2014 having minimum 1.2 mm thick outer bottom (size 75.50 mm, 32mm, 0.605 kg/m), minimum 1.2 mm thick outer top (size 75.50 mm, 28.50 mm, 0.705 kg/m), minimum 1.2 mm thick shutter bottom (size 33 mm, 26.80 mm, 0.42 kg/m), minimum 1.2 mm thick shutter side (size 75.50 mm, 19.90 mm, 0.52 kg/m), minimum 1.2 mm thick shutter lock (size 49.20 mm, 25.80 mm, 0.543 kg/m) and minimum 1.2mm thick interlock (size 34.40mm, 32.13mm, 0.562 kg/m) sections all aluminium members will be anodized to aluminium bronze/silver/ss/black colour with a coat not less than 15 microns in thickness or powder coated to any colour with a coat not less than 25 microns in thickness and density of 4 mg per square cm etc. including all accessories like sliding door key lock, sliding door wheel, sliding door mohar, sliding door neoprene, bolts and nuts including sealants, keeping provision for fitting 5 mm thick glass including labour charge for fitting of accessories, making grooves and mending good damages, carriage, and electricity complete in all respect as per drawing and accepted by the Engineer-in-charge. Size up to: 900 mm x 1400 mm. Anodized to any colour	sqm	0.5		
6	Civil	14.16 14.16.1.1.1	Supplying, fitting and fixing in Aluminium door frames, windows, partitions and curtain wall distortion free glass of approved quality and shade including cost of fitting fixing all necessary accessories etc. complete in all respect as per drawing and accepted by the Engineer-in-charge.	sqm	0.5		

 সিনিয়র ইঞ্জিনিয়ার (সিভিল)
 পাবনা জেলা পানি সরবরাহ প্রকল্প
 পাবনা জেলা পানি সরবরাহ প্রকল্প

Item No.	Group	Item Code SoR-2022 of PWD	Description of Item:	Measure ment Unit	Total Qty.	Unit Rate (Barisal) Taka	Amount (Taka)
7	Civil	15.1.1 15.16	Minimum 12 mm thick cement sand (F.M. 1.2) plaster (1:4) with fresh cement to both inner-and outer surface of wall, finishing the corner and edges including washing of sand, cleaning the surface, curing at least for 7 days, cost of water, electricity, scaffolding and other charges etc. all complete in all respect as per drawing and accepted by the Engineer-in-charge. (Cement: CEM-II/B-M) 2nd floor.	sqm	8		
8	Civil	16.1.1	Exterior standard acrylic emulsion paint of approved best quality and color having water resisting properties and resistance properties against fungi, fading & flaking delivered from authorized local agent of the manufacturer in a sealed container: applying to exterior surface with surface preparation including cleaning, drying, making free from dirt, grease, wax, removing all chalked and scaled materials, fungus, mending good the surface defects using sand paper and necessary scaffolding; applying necessary exterior sealer of specified brand on prepared surface; then applying necessary exterior putty of specified brand for levelling, spot filling, crack filling and cutting by sand paper/zero water paper; finally applying 2 coats of exterior emulsion paint spreading by brush/roller/spray & necessary scaffolding etc. upto desired finishing, elapsing specified time for drying or recoating; all complete in all floors and accepted by the Engineer-in-charge.	sqm	13		
9	Civil	16.2.1	Interior standard acrylic emulsion paint (plastic or matt finish) of approved best quality and colour delivered from authorized local agent of the manufacturer in a sealed container; applying to interior wall and ceiling with surface preparation including cleaning drying, making free from dirt, grease, wax, removing all chalked and scaled materials, fungus, mending good the surface defects using sand paper and necessary scaffolding; applying necessary interior sealer of specified brand on prepared surface; then applying necessary interior putty of specified brand for levelling, spot filling, crack filling and cutting by sand paper/zero water paper; finally applying 2 coats of interior emulsion paint spreading by brush/roller/spray & necessary scaffolding etc. upto desired finishing, elapsing specified time for drying or recoating; all complete in all floors and accepted by the Engineer-in-charge.	sqm	8		

 (স্বাক্ষরিত) (স্বাক্ষরিত) (স্বাক্ষরিত)
 (স্বাক্ষরিত) (স্বাক্ষরিত) (স্বাক্ষরিত)

Item No.	Group	Item Code SoR-2022 of PWD	Description of Item	Measure ment Unit	Total Qty.	Unit Rate (Barisal) Taka	Amount (Taka)
10	Civil	16.3.1	Standard synthetic enamel paint of approved best quality and colour delivered from authorized local agent of the manufacturer in a sealed container, having high water resistance, high bondability, flexibility property, using specified brand thinner applying to metallic or wooden surface by brass/roller/spray in 2 coats over single coat anti-corrosive coating including cleaning, drying, making free from dirt, grease, wax, removing all chalked and scaled materials, all complete in all floors and accepted by the Engineer-in-charge.	sqm	0.5		
11	Civil	16.11	Approved best quality and colour synthetic polyvinyl distemper delivered from authorized local agent of the manufacturer in a sealed container, applying to wall and ceiling with surface preparation including cleaning drying, making free from dirt, grease, wax, removing all chalked and scaled materials, fungus, mending good the surface defects using sand paper and necessary scaffolding; applying 1 coat of interior sealer of specified brand on prepared surface; then applying 1 coat of interior putty of specified brand for levelling, spot filling, crack filling and cutting by sand paper/zero water paper; finally applying 2 coats of synthetic polyvinyl distemper spreading by brush/roller/spray & necessary scaffolding etc. up to desired finishing, elapsing specified time for drying or recoating; all complete in all floors and accepted by the Engineer-in-charge.	sqm	2		
12	Civil	32.1	Stripping of unserviceable plaster including racking out joints, cleaning etc.	sqm	6		
13	Civil	32.118	Taking out old unserviceable Aluminium Door/ window frame and shutter etc. all completed as per direction of Engineer-in-charge.	sqm	3.5		
14	Civil	Analized Item	Taking out old window and ver. grill etc. including cleaning, stacking or storing all completed as per direction of Engineer-in-charge.	sqm	9		
						Total Tk. =	

In word: Taka Forty nine thousand four hundred ninety eight and paisa fifty only.



মোহাম্মদ আবদুল হাম্মিদ
একিউস (প্রোগ্রাম/এইজার)
সার্বভৌমত্ব পবিত্র

02. Part – B : Sanitary Works .

Item No.	Group	Item Code SoR-2022 of PWD	Description of item	Measurement Unit	Total Qty.	Unit Rate (Dhaka) Taka	Amount (Taka)
1	sanitary	26.01 26.01.1	Supplying, fitting and fixing of European type country made best quality glazed porcelain combi closet (two piece), including plastic seat cover with soft closing cistern system, water consumption 6 litre, siphon wash down/siphon jet single or dual flushing system which reduce water consumption, hygienic glaze in toilet bowl, glaze in inner waste line, round bowl, outlet range 280-305 mm. The sanitary ware shall conform BDS1162:2014. The glaze shall be thoroughly fused to body. The minimum thickness of body at any section shall be 5 mm. When assembled together and when examined from a distance of 60 cm, the outer surface shall not show to the unaided eye, blemishes or defects in excess of those listed in BDS standard. The mean value of water absorption shall not be greater than 0.5% of the ware when dry. When tested with chemical solutions (Acetic acid, Citric acid, Detergent, Hydrochloric acid, Sodium hydroxide, Sodium stearate and Sulfuric acid of various strength) as per BDS1162:2014 procedure, none of the test pieces should suffer any loss of reflectivity on the glaze. There shall be no crazing and no stain on the ware. The materials used for making glazes shall not contain lead compound. In case of certain coloring oxides used for making colored glaze, the lead content, if any, shall not exceed 5 percent of the weight of the glaze materials. Appliances shall be clearly and indelibly marked at a prominent place, visible even after the appliances are installed with the following: a) manufacturer's name and/or registered trademark, b) the number of Bangladesh standard and c) country of origin. Each product shall also be marked with the BSTI Certification Mark. The fixture should be placed in position preparing the base with cement concrete and with wire mesh or rods if necessary, in all floors including making holes wherever required and mending good the damages and fitting, fixing, finishing, complete with all	each	1		
2	sanitary	26.12 26.12.6	Supplying, fitting and fixing of country made glazed vitreous W/H wash basin excluding pedestal. The sanitary ware shall conform BDS1162:2014. The glaze shall be thoroughly fused to body. The minimum thickness of body at any section shall be 5 mm. When assembled together and when examined from a distance of 60 cm, the outer surface shall not show to the unaided eye, blemishes or defects in excess of those listed in BDS standard. The mean value of water absorption shall not be greater than 0.5% of the ware when dry. When tested with chemical solutions (Acetic acid, Citric acid, Detergent, Hydrochloric acid, Sodium hydroxide, Sodium stearate and Sulfuric acid of various strength) as per BDS1162:2014 procedure, none of the test pieces should suffer any loss of reflectivity on the glaze. There shall be no crazing and no stain on the ware. The materials used for making glazes shall not contain lead compound. In case of certain coloring oxides used for making colored glaze, the lead content, if any, shall not exceed 5 percent of the weight of the glaze materials. Appliances shall be clearly and indelibly marked at a prominent place, visible even after the appliances are installed with the following: a) manufacturer's name and/or registered trademark, b) the number of Bangladesh standard and c) country of origin. Each product shall also be marked with the BSTI Certification Mark. The fixture should be placed in position with heavy type C.I.Brackets. 30 mm dia PVC waste water pipe with brass coupling (not exceeding 750 mm in length), basin waste with chain plug including making holes in walls and floors and fitting with wall, screws and mending good the damages, finishing etc. all	each	1		

স্বাক্ষরিত
মোহাম্মদ আবদুল হামিদ
পরিচালক (প্রশাসন/প্রকল্প)
পানি-এম (প্রশাসনিক পরিদপ্তর)

Item No.	Group	Item Code SoR-2022 of PWD	Description of Item	Measurement Unit	Total Qty.	Unit Rate (Dhaka) Taka	Amount (Taka)
3	sanitary	26.15	Supplying, fitting and fixing basin pedestal of Approx. size of 670 mm x 186 mm x 170 mm, any color with towel plug and screws etc. all complete approved and accepted by the Engineer-in-charge.	each	1		
4	sanitary	26.19.2	Supplying, fitting and fixing of 5 mm thick unframed super quality double coated mirror with all necessary fitting including making holes in walls and mending good the damages with cement mortar (1:4) etc. all complete approved and accepted by the Engineer-in-charge.	each	1		
5	sanitary	26.20	Supplying, fitting and fixing of super quality 600 mm x 125 mm coloured glass (plate) shelf having 5 mm thickness with fancy C.P. brackets, screws and frames including making holes in walls and mending good the damages with cement mortar (1:4) etc. all complete approved and accepted by the Engineer-in-charge.	each	1		
6	sanitary	26.22 26.22.1	Supplying, fitting and fixing of country made best quality towel rail/ring/shelf minimum 20 mm in dia with C.P. holder including making holes in walls and mending good the damages with cement mortar (1:4) etc. all complete approved and accepted by the Engineer-in-charge.	each	1		
7	sanitary	26.23 26.23.4	Supplying, fitting and fixing of best quality toilet paper holder of standard size including making holes in walls and mending good the damages with cement mortar (1:4) etc. all complete approved and accepted by the Engineer-in-charge. Stainless steel toilet paper holder	each	1		
8	sanitary	26.24 26.24.4	Supplying, fitting and fixing of standard size country made soap tray including making holes in walls and mending good the damages with cement mortar (1:4) etc. all complete approved and accepted by the Engineer-in-charge. Stainless steel soap tray	each	1		
9	sanitary	26.27 26.27.2	Supplying, fitting and fixing of floor grating net in traps or in drains including making holes in walls/floors and mending good the damages with cement mortar (1:4) etc. all complete approved and accepted by the Engineer-in-charge. of following type Approx. 100~125 mm dia stainless steel floor grating net	each	1		
10	sanitary	26.29 26.29.1	Supplying, fitting and fixing of best quality country made 12 mm bib cock made from copper or copper alloy, chromium plated. The faucet conforms BDS EN 200:2009. The faucet tap shall be free from any leakage, permeation and other abnormalities. The water hammer value shall be 1.47 Mpa or under. The faucet after it has been operated 100000 times it shall be free from a seat-leakage and shall satisfy the reverse flow preventing performance. The inside and outside surfaces of the faucet shall be smooth and be free from blowholes, fissures, remarkable flows or injurious defects. The chromium plating on the faucet shall be of class 2 grade 1. The final coating should be done with chromium of minimum 0.1 micron. The faucet shall be made leak proof and fixing in position with selected tape etc., all complete approved and accepted by the Engineer-in-charge. Round headed CP Conceal Bib Cock short body	each	1		

 মোহাম্মদ আব্দুল হামিদ
 এজিকিউটিভ (প্রশাসন/এইচআর)
 নারায়ণগঞ্জ পল্লী-১

Item No.	Group	Item Code SoR-2022 of PWD	Description of Item	Measurement Unit	Total Qty.	Unit Rate (Dhaka) Taka	Amount (Taka)
11 (a)	sanitary	26.30 26.30.1	Supplying, fitting and fixing of best quality surface mounted or conceal stop cock/ angle stop cock (lever or round headed) with wall flange chromium plated. The faucet conforms BDS EN 200:2009. The faucet tap shall be free from any leakage, permeation and other abnormalities. The water hammer value shall be 1.47 Mpa or under. The faucet after it has been operated 100000 times it shall be free from a seal-leakage and shall satisfy the reverse flow preventing performance. The inside and outside surfaces of the faucet shall be smooth and be free from blowholes, fissures, remarkable flows or injurious defects. The chromium plating on the faucet shall be of class 2 grade 1. The final coating should be done with chromium of minimum 0.1 micron. The faucet shall be made leak proof and fixing in position with selected tape etc., all complete approved and accepted by the Engineer-in-charge. (a) 12 mm dia CP Concealed Stop Cock	each	1		
11 (b)	sanitary	26.30.4	(b) CP angle stop cock	each	2		
12	sanitary	26.31 26.31.2	Supplying, fitting and fixing of best quality pillar cock made from copper or copper alloy, chromium plated materials. The faucet conforms BDS EN 200:2009. The faucet tap shall be free from any leakage, permeation and other abnormalities. The water hammer value shall be 1.47 Mpa or under. The faucet after it has been operated 100000 times it shall be free from a seal-leakage and shall satisfy the reverse flow preventing performance. The inside and outside surfaces of the faucet shall be smooth and be free from blowholes, fissures, remarkable flows or injurious defects. The chromium plating on the faucet shall be of class 2 grade 1. The final coating should be done with chromium of minimum 0.1 micron. The faucet shall be made leak proof and fixing in position with selected tape etc., all complete approved and accepted by the Engineer-in-charge.	each	1		
13	sanitary	26.39 26.39.1	Supplying and fitting-fixing stainless steel hand / push shower for ablation including holder etc. all complete approved and accepted by the Engineer-in-charge. Moving type push shower	meter	1		
14	sanitary	26.43.2	Supplying different inside dia best quality uPVC soil, waste and ventilation pipe having specific gravity 1.35 - 1.45, wall thickness 2.5 mm - 3.0 mm, and other physical, chemical, thermal, fire resistivity properties etc. as per BSTI approved manufacturer standards or ASTM, BS/ISO/IS standards fitting and fixing in position with sockets, bends, of uPVC Pipe with all accessories such as Round grating / domed roof grating bands, sockets etc. approved and accepted by the Engineer-in-charge. 100 mm inside dia wall thickness 3.4- 4.0 mm	meter	55		
15 (a)	sanitary	26.45 26.45.3	Supplying different inside dia best quality uPVC pressure pipe for water supply having specific gravity 1.35 - 1.45, and other physical, chemical, thermal, fire resistivity properties etc. as per BSTI approved manufacturer standards or ASTM, BS/ISO/IS standards fitted and fixed in position with sockets, bends, with all accessories such as Round grating/domed roof grating, bends, sockets etc. approved and accepted by the Engineer-in-charge.	meter	6		
15 (b)	sanitary	26.45.4	(b) 32 mm dia wall thickness 2.7 mm - 3.6 mm	meter	2		
15 (c)	sanitary	26.45.5	(c) 37 mm dia wall thickness 2.5 mm - 3.1 mm	meter	30		

মোহাম্মদ আবদুল হামিদ
এইজেন্ট (প্রোগ্রাম/একিউজার)
শাহাদাতপুর পল্লী-২

Item No.	Group	Item Code SoR-2022 of PWD	Description of Item	Measurement Unit	Total Qty.	Unit Rate (Dhaka) Taka	Amount (Taka)
16 (a)	sanitary	26.46 26.46.1	Supplying different inside dia best quality CPVC pressure pipe for water supply having specific gravity 1.35 - 1.45, and other physical, chemical, thermal, fire resistivity properties etc. as per BSI approved manufacturer standards or ASTM, BS/ISO/IS standards fitting and fixing in position with sockets, bends, with all accessories such as round grating/domed roof grating, bends, sockets etc. approved and accepted by the Engineer-in-charge	meter	1		
16 (b)	sanitary	26.46.2	(b) 19 mm dia wall thickness 2.9 mm - 3.4 mm	meter	6		
17	sanitary	26.51 26.51.5	Supplying, fitting and fixing of G.I. Union with sealant etc. complete in all respects approved and accepted by the Engineer-in-charge. 40 mm dia G.I. Union	each	1		
18(a)	sanitary	26.52 26.52.3	Supplying, fitting and fixing of best quality G.I. gate valve with sealant etc. complete approved and accepted by the Engineer-in-charge. (a) 25 mm dia G.I. Union	each	1		
18 (b)	sanitary	26.52.5	(b) 40 mm brass gate valve	each	1		
19	sanitary	26.56 26.56.4	Supplying different inside dia best quality uPVC clean out / trap having specific gravity 1.35 - 1.45 and other physical, chemical, thermal, fire resistivity properties etc. as per BSI approved manufacturer standards or ASTM, BS/ISO/IS standards, fitting and fixing in position etc. complete approved and accepted by the Engineer-in-charge. 100 mm dia uPVC 'P' or 'S' trap	each	1		
20	sanitary	26.61 26.61.4	Supplying, fitting and fixing of 12 mm dia connection pipe approved and accepted by the Engineer-in-charge. 600 mm long metal cover connection pipe	each	1		
21	sanitary	26.67 26.67.1	Groove cutting in brick work and R.C.C work, including cost for concealing of water distribution pipe work (12 mm and 20 mm dia) in brick wall by cutting groove in wall, lintel, beam etc. by any means carefully without damaging the structure and filling the grooves with C.C (4:2:1) after laying of pipe including cost of scaffolding, finishing, curing etc. all complete approved and accepted by the Engineer-in-charge. Groove size 40 mm x 40 mm (For laying 12 mm to 20 mm dia pipes)	meter	7		
						Total Tk. =	

In Word: Taka Ninety nine thousand one hundred fifty one only.



স্বাক্ষরিত আবদুল হামিদ
এস.এস. (প্রশাসন/এইচআর)
নির্বাহিত পক্ষ

03.Part-C : Electrical Works.

Item No.	Group	Item Code SoR-2022 of PWD	Description of Item	Measurement Unit	Total Qty.	Unit Rate (Barisal) Taka	Amount (Taka)
1	Electrical	Sub-Head-1 1.6 1.6.1 1.6.1.1	CONCEALED CONDUIT POINT WIRING (BYM) WITHOUT SWITCH Concealed conduit wiring for following point looping at the switch board with earth terminal with 1C-2x1.5 sqmm PVC insulated and sheathed stranded cable (BYM) & 1C-2x1.5 sqmm PVC insulated ECC (BYA) (Green / yellow bi colour) including circuit wiring with (From SDB to Switch Board) 1C-2x2.5 sqmm PVC insulated and sheathed stranded cable (BYM) & 1C-2x2.5 sqmm PVC insulated ECC (BYA) Green / Yellow bi-colour through PVC conduit (one conduit from switch board to common point on ceiling is considered to draw 3 pair of cable) of reputed manufacturer of minimum 25 mm dia & 1.7 mm wall thickness complete with 18 SWG GP sheet / PVC switch board & pull box with 3mm thick ebonite sheet cover, without switch, fixing materials etc.(without switch) as required including mending the damages good. All electrical contacts shall be of brass / copper connected through connector or soldering (no twisting shall be allowed) and cables shall be manufactured and tested according to IEC / BS / VDE standards along with relevant BDS standard as per detailed specification mentioned in Annexure-1. The work shall be carried out as per direction & approval of the Engineer In Charge. Cables manufactured by Govt. of Bangladesh owned / shared company ltd. (Eastern cables) approved by the Engineer In Charge.	point	2		
2	Electrical	Sub-Head-1 1.15 1.15.1 1.15.1.2	CONCEALED WIRING (BYM) Concealed conduit wiring with following PVC insulated and sheathed stranded cable (BYM) & PVC insulated Green / Yellow bi-coloured ECC wire (BYA) through PVC conduit of reputed manufacturer complete with 18 SWG GP sheet pull box with 3mm thick ebonite sheet cover, fixing materials etc. as required including mending the damages good. All electrical contacts shall be of brass / copper connected through connector or soldering (no twisting shall be allowed) and cables shall be manufactured and tested according to IEC / BS / VDE standards along with relevant BDS standard as per detailed specification mentioned in Annexure- 1. The work shall be carried out as per direction & approval of the Engineer In Charge. Cables manufactured by Govt. of Bangladesh owned / shared company ltd. (Eastern cables) approved by the Engineer in Charge 1C-2x2.5sqmm (BYM) cable with 2.5sqmm (BYA) ECC wire through PVC pipe of minimum inner Dia. 16 mm having wall thickness of 1.5 mm	meter	5		
3	Electrical	4.12 4.12.2 4.12.2.2	GANG SWITCH Providing & fixing 250 volts, 5 / 6 amps (minimum) concealed type following switch / switch socket manufactured / Assembled and tested in accordance with IEC / VDE / NEMA / BS / JIS along with relevant BDS IEC standards mounted on required size 18 SWG galvanized plain sheet / PVC board (Self-extinguishing 650 °C) of 76.2 mm (3") depth. All electrical contacts shall be of brass / copper. Made in HONGKONG / MALAYSIA / SINGAPORE / S KOREA / THAILAND Two gang switch	each	1		

মোহাম্মদ আবদুল হামিদ
এইচ.ই.ই. (প্রোগ্রাম/এইচআর)
১৩০৩

Item No.	Group	Item Code SoR-2022 of PWD	Description of item	Measurement Unit	Total Qty.	Unit Rate (Barisal) Taka	Amount (Taka)
4	Electrical	6.4 6.4.1 6.4.1.1	BATHROOM LIGHT FITTING Providing & fixing of the bath-room light fitting consisting of oxidized or golden or chromium plated brass base with carrier, brass holder, earth terminal, necessary wiring with 2x 0.4 sq.mm stranded PVC insulated flexible for use of LED lamp and complete sample to be accepted / approved by the engineer-in-charge (with 2 years warranty). Light source 9W LED Bulb Material: SS Sheet, SS/Brass pipe (Dia -10 mm), Aluminium Sheet, glass L-350 mm B-120 mm P-90 mm GLORIA cat.no-GBB-959-2105-FR Energy+ Cat.no-BDTCL-MLF-01 Asha Cat.no.ACS-BB 2602 TTG	each	1		
5	Electrical	6.20 6.20.3	LED BULBS & TUBE LAMPS Supply & fixing of the following LED bulbs & tube lamps manufacturers by OSRAM / SIGNIFY(PHILIPS) / ENERGYPAC / CBE / CORONA / HAVELLS / GE / EOlSlON / EASTERN / PROOIP / MEP / METRO / / Magaman/ Walton/HARMONICS / SUPERSTAR / TRANSTEC / ENERGY+ Gloria / Adex / PASHA / SQ / Click / COSMO or equivalent brand accepted / approved by the Engineer. (with 2 years warranty). 7 watt LED bulb	each	1		
6	Electrical	21.2 21.2.1	EXHAUST FAN providing and fixing of following axial flow AC capacitor type wall mounted exhaust fan complete with blade steel frame standard wall louver shutter,PVC insulated connecting wire etc complete as required including cutting wall and mending good the damages as per direction of the Engineer 8" Exhaust fan plastic body (foreign made accepted / approved by the Engineer).	each	1		
Total Tk =							

In Word: Taka Seven thousand six hundred nine only.

মোহাম্মদ আবদুল হামীন
 এঞ্জিনিয়ার (প্রশাসন/এইচআর)
 সার্বভৌমতা পরিদপ্তর-১

COST ESTIMATES FOR CONSTRUCTION OF 5-STORIED F- TYPE (2-UNITS) RESIDENTIAL BUILDING- 01 WITH 6-STORIED FOUNDATION AT BARISAL PALLI BIDYUT SAMITY-02, HEAD QUARTER, P.O: CADET COLLEGE, BARISAL.
 Old tender estimate Reference + copy

Sl. No.	Location / Component	Length (ft)	Width (ft)	Height / Depth (ft)	Area / Volume (sft/cft)	No. of Items	Quantity of Works (sqm/cum/nos)	Unit
1	5" Brick Work							
	2nd Floor Brick Work							
	Toilet	13	5		65.000	1	6.04	sqm.
	Window	4	5		20.000	1	1.86	sqm.
	Sum of Brick Work						7.90	sqm.
2	12mm Plaster							
	2nd Floor Outer side							
	Toilet	13	5		65.000	1	6.04	sqm.
	Window	4	5		20.000	1	1.86	sqm.
	Sum of Brick Work						7.90	sqm.
3	Floor Tiles							
	Floor Tiles	3	7		21.000	1	1.95	sqm.
4	Wall Tiles							
	Gril wall	20	7		140.000	1	13.01	sqm.
5	High Window							
	Thai window	2.5	2		5.000	1	0.46	sqm.
6	High Window							
	5mm thick tinted glass	2.5	2		5.000	1	0.46	sqm.
7	High Window							
	10mm x10mm ms bar gril	2.5	2		5.000	1	0.46	sqm.
8	Weather coat							
	Toilet outer side	13	10		130.000	1	12.08	sqm.
9	Plastic Paint							
	Toilet inside	20	3		60.000	1	5.58	sqm.
	Window inside	4	5		20.000	1	1.86	sqm.
	Sum of above item						7.43	sqm.
10	Distemper							
	Toilet ceiling	7	3		21.000	1	1.95	sqm.

(Signature)
 P. K. SARKAR (Sd/-) (Sd/-) (Sd/-)
 P. K. SARKAR (Sd/-) (Sd/-) (Sd/-)

Sl. No.	Location / Component	Length (ft)	Width (ft)	Height / Depth (ft)	Area / Volume (sqft/cft)	No. of Items	Quantity of Works (sqm/cum/nos)	Unit
11	Enamel paint 10mm x10mm ms bar grill	2.5	2		5.000	1	0.46	sqm.
12	Taking out Old plaster wall	20	2.5		50.000	1	4.65	sqm.
	Sum of above item	3	3		9.000	1	0.84	sqm.
13	Taking out old Grill wall	13	4.5		58.500	1	5.44	sqm.
	Window grill	4	4.5		18.000	2	3.35	sqm.
	Sum of above item						8.78	sqm.
14	Taking out Thai window Window	4	4.5		18.000	2	3.35	sqm.
	Sum of above item						3.35	sqm.
							3.35	sqm.



মোহাম্মদ আবদুল হাম্মান
এক্স-এম (প্রশাসন/এইচআর)
শারাদাঙ্গা পল্লী-১